

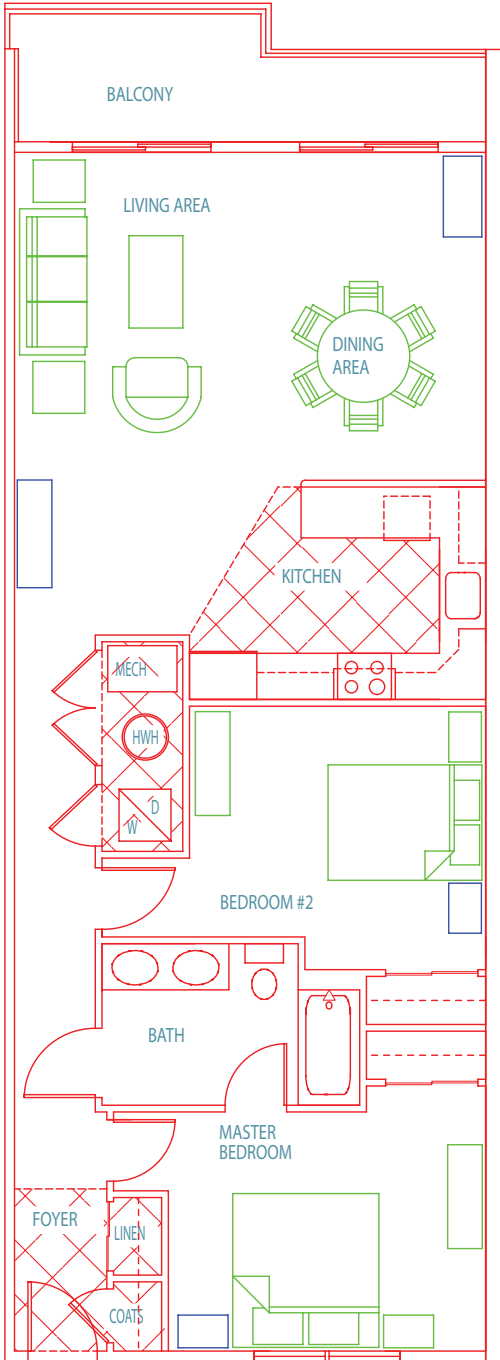

Basic Furniture Package
 Optional Furniture



UNIT 108, 208, 308

1123 S.F. TOTAL LIVING AREA
 105 S.F. BALCONY AREA
 1228 S.F. TOTAL AREA

Monarch North			
2 Bedroom - Center units facing north			
Unit #'s 108, 208, 308			
Basic Furniture package			<input type="checkbox"/>
Furniture Options at additional cost			<input type="checkbox"/>
Master BR	Piece	Description	Cost
1	night stand	Broyhill - Pleasant Isle	Included
1	dresser drawer	Broyhill - Pleasant Isle	Included
1	landscape mirror	Broyhill - Pleasant Isle	Included
1	king headboard 6/0-6/6	Broyhill - Pleasant Isle	Included
1	king box set/mattress		Included
1	king bed frame		Included
Option 1	night stand	Broyhill - Pleasant Isle	\$260
BDRM #2			
1	night stand	Broyhill - Pleasant Isle	Included
1	dresser drawer	Broyhill - Pleasant Isle	Included
1	landscape mirror	Broyhill - Pleasant Isle	Included
1	queen headboard 4/6-5/0	Broyhill - Pleasant Isle	Included
1	queen box set/mattress		Included
1	queen bed frame		Included
Option 1	night stand	Broyhill - Pleasant Isle	\$260
Dining Room			
1	round table w/ 24" leaf	Wynwood Hampton Cove	Included
6	ladder back side chairs	Wynwood Hampton Cove	Included
1	Dining side board	Wynwood Hampton Cove	\$660
Living Room			
1	queen sleep sofa	Flexsteel	Included
1	large easy chair	Flexsteel - Montreal	Included
1	end table	Broyhill - Pleasant Isle	Included
1	square lamp table	Broyhill - Pleasant Isle	Included
1	rectangular cocktail table	Broyhill - Pleasant Isle	Included
Option 1	door chest w/TV cabinet	Broyhill - Pleasant Isle	\$600
Blinds - Option			
Hunter Douglass Woodmates with standard valance			\$901
Total Optional Furniture Cost			\$2,682
Shipping			\$302
Handling			\$134
Tax			\$161
Option	Total Optional Cost		\$3,279

Optional Furniture & Pricing will be confirmed at time of purchase.